

NEW for Summer 2021

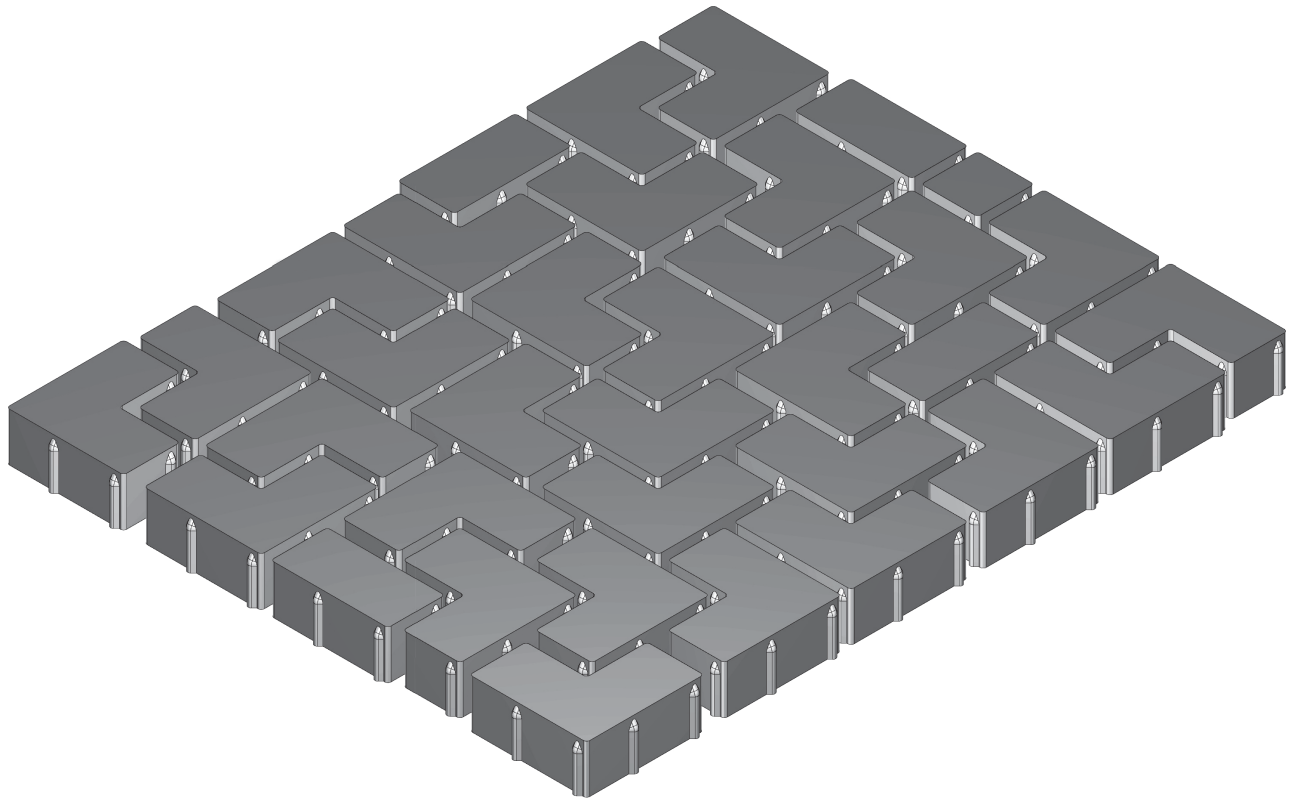

Permeable Interlocking Concrete Paver (PICP) designed for maximum efficiency through mechanical installation achieving a 6% void space for drainage

DC 80 - NEW

ALL COLOURS ARE
SPECIAL ORDER

SHAPES & SIZES

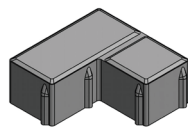

BLOCK 1
7.6" x 7.6" (3.7" at
ends of "L") x 2.76"
193 x 193mm (93mm at ends
of "L") x 80mm

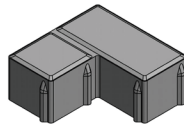

BLOCK 2
7.6" x 7.6" (3.7" at ends of "L")
x 2.76"
193mm x 193mm (93mm at
ends of "L") x 80mm

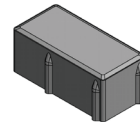

BLOCK 3
3.7" x 7.6" x 2.76"
93mm x 193mm x 80mm

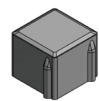

BLOCK 4
3.7" x 3.7" x 2.76"
93mm x 93mm x 80mm

